

# Hammer

#3 drill, .540 deep  
1/4" spot counterbore  
Tap 1/4-28

5/8 dia. brass rod

Put slight 45° bevel on edges

Head

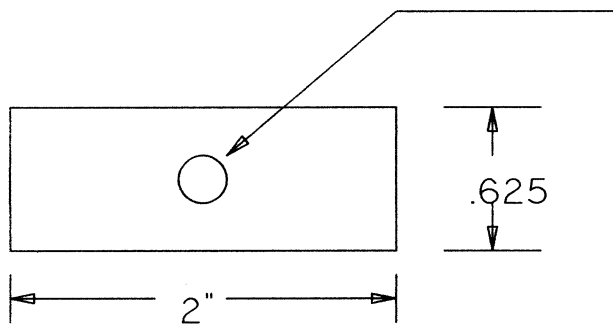

Handle

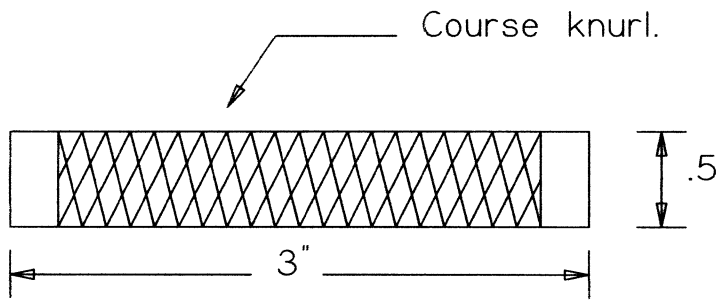

1/2" dia. brass rod

Knurl entire rod and then turn 1/4" clean on both ends.

Drill one end, #3 drill, 1" deep.  
1/4" counterbore, .125 deep.  
Tap 1/4-28

1/4" dia. drill rod

Shaft

